

# SB/SBA



Further product  
documentation



[net.grundfos.com/qr/i/99057358](https://net.grundfos.com/qr/i/99057358)

SB  
SBA

STRAINER

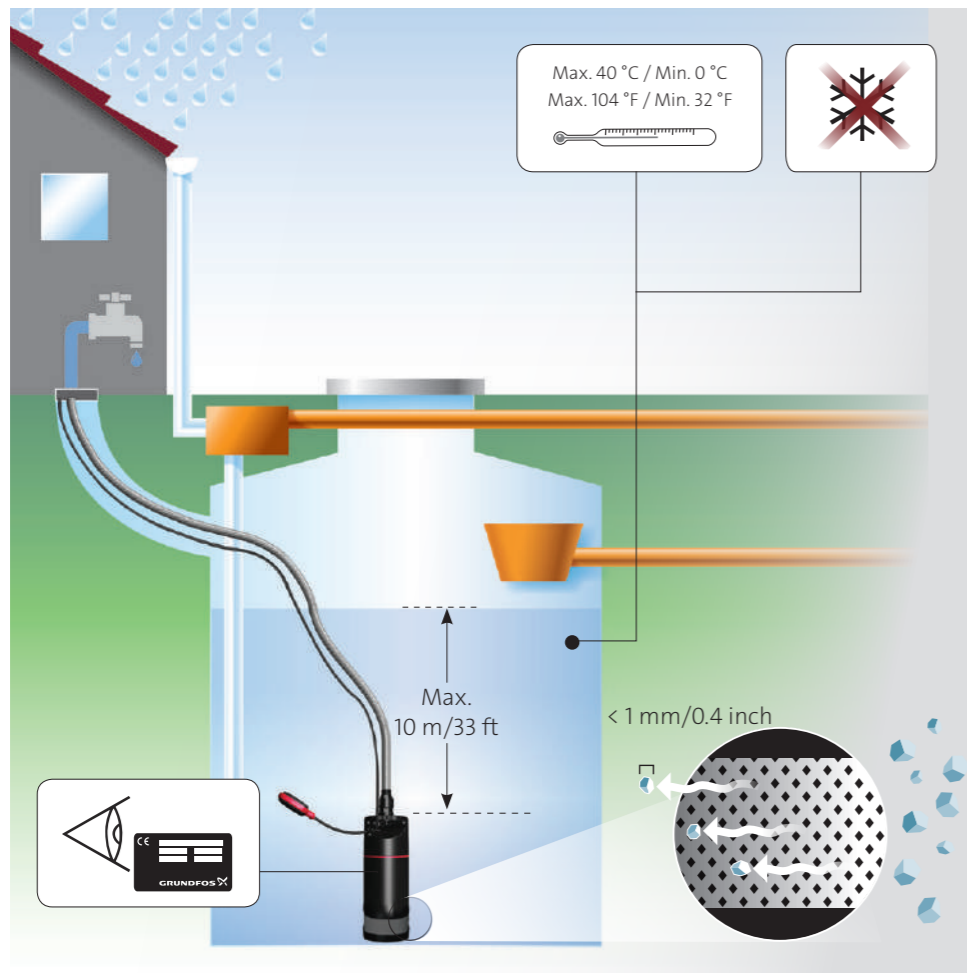

SB  
SBA

SIDE INLET

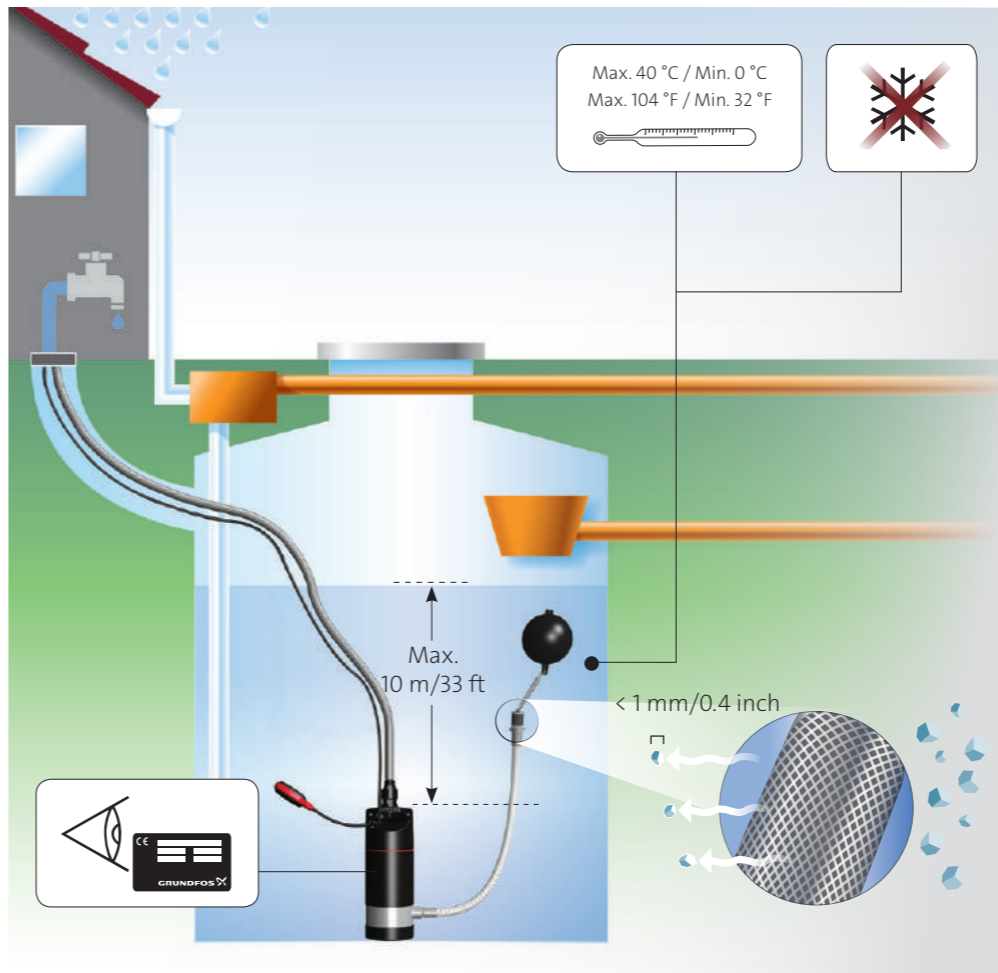

SBA 3-35

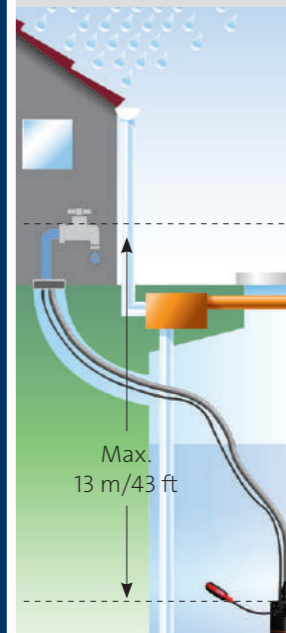

SBA 3-45

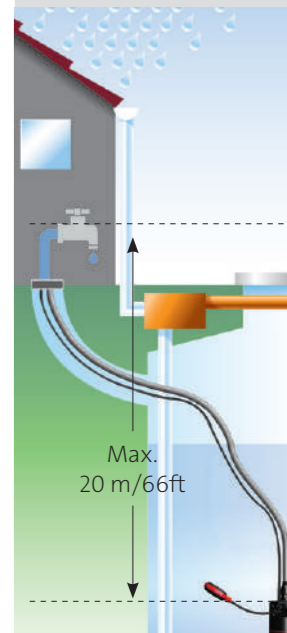

SB

STRAINER

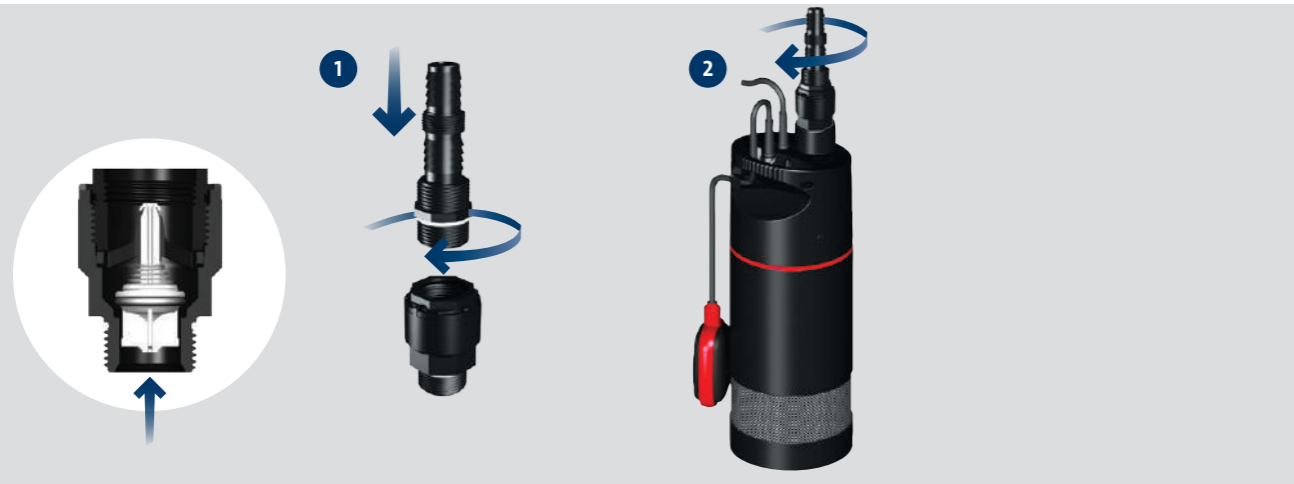

SBA

STRAINER



SB

SIDE INLET

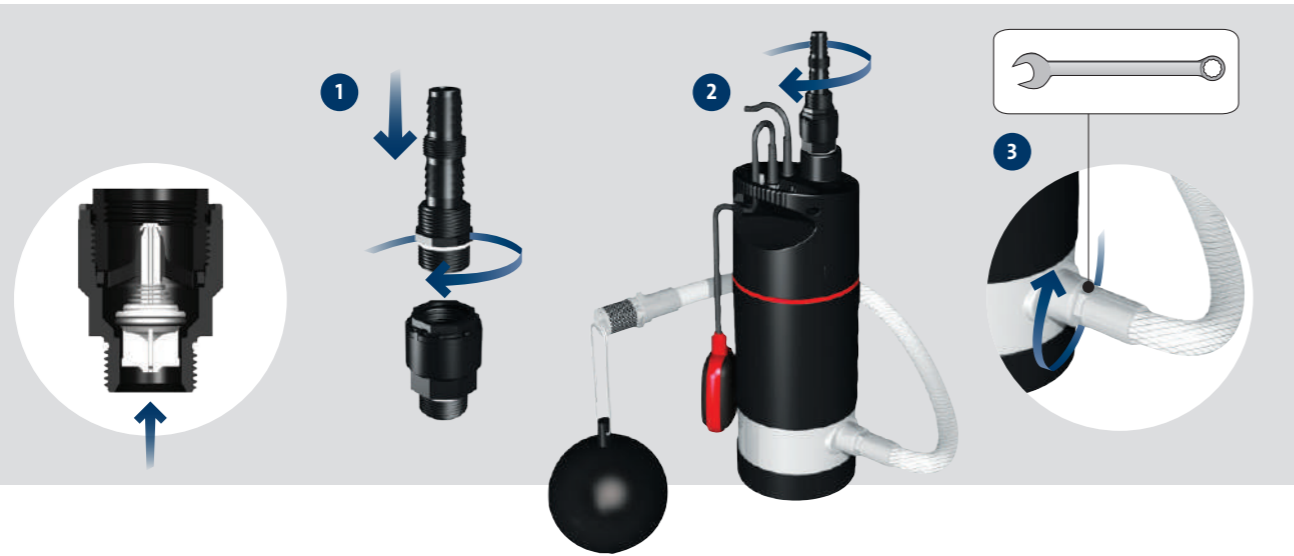

SBA

SIDE INLET



**SB**  
**SBA**

**STRAINER**

**SIDE INLET**

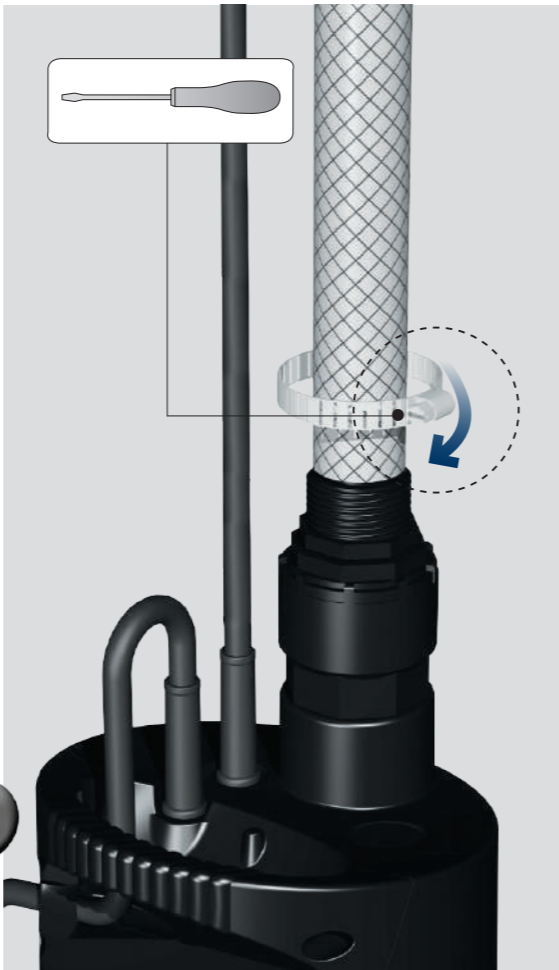
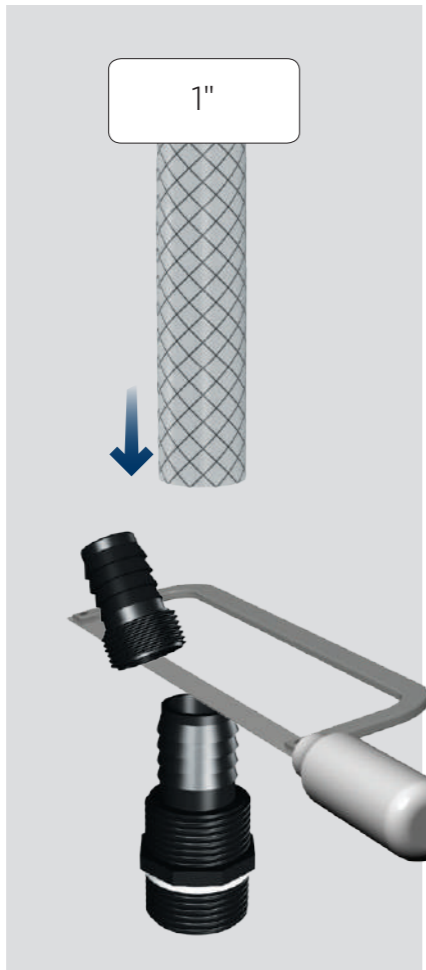
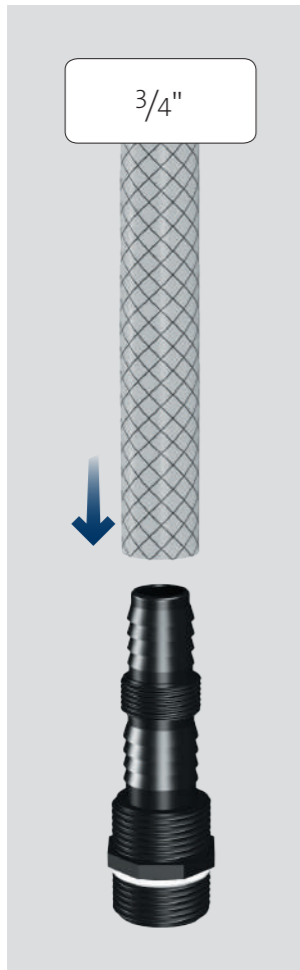

**SB**  
**SBA**

**STRAINER**

**SIDE INLET**

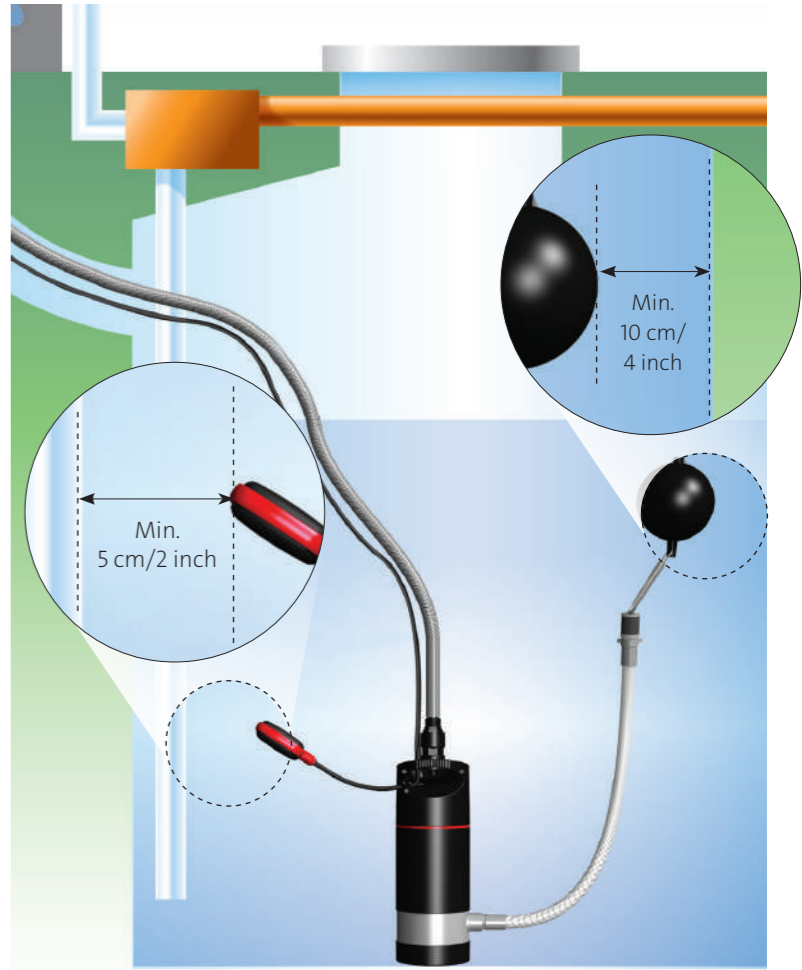
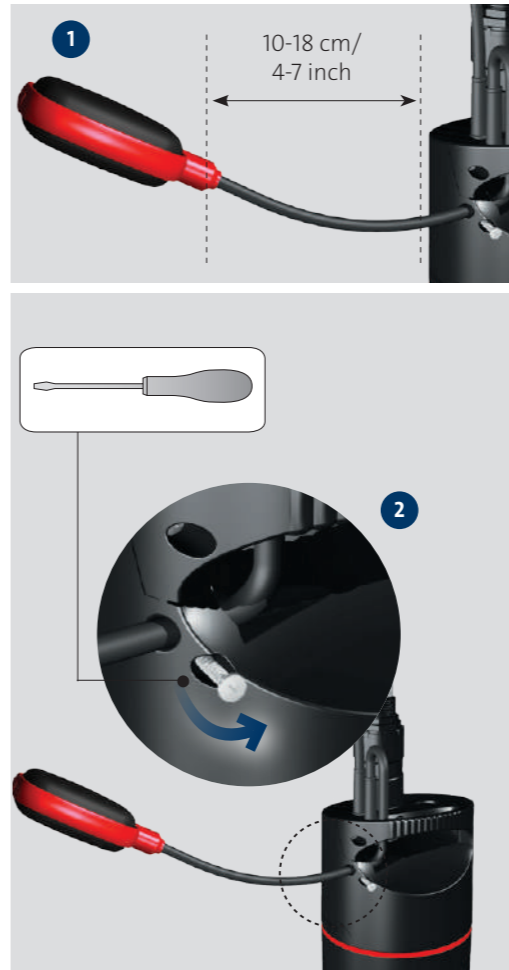

SB

STRAINER

SIDE INLET

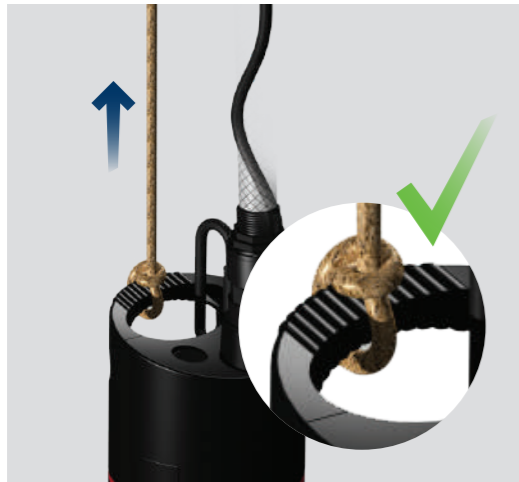

SBA

STRAINER

SIDE INLET

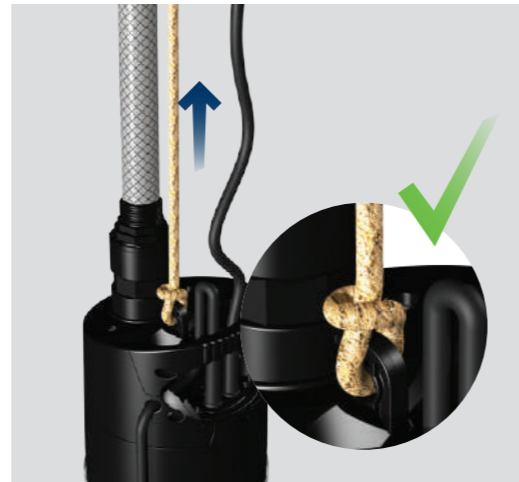
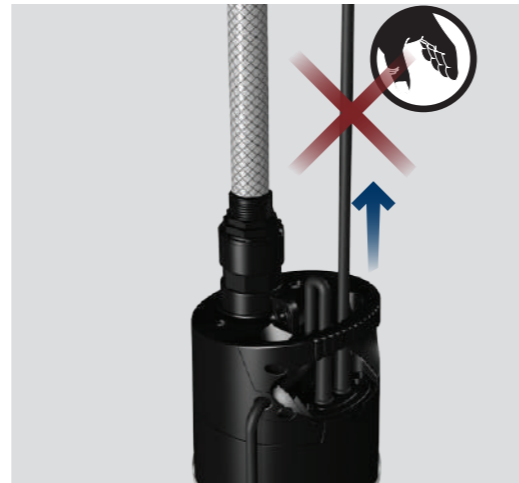

SB  
SBA

STRAINER

SIDE INLET

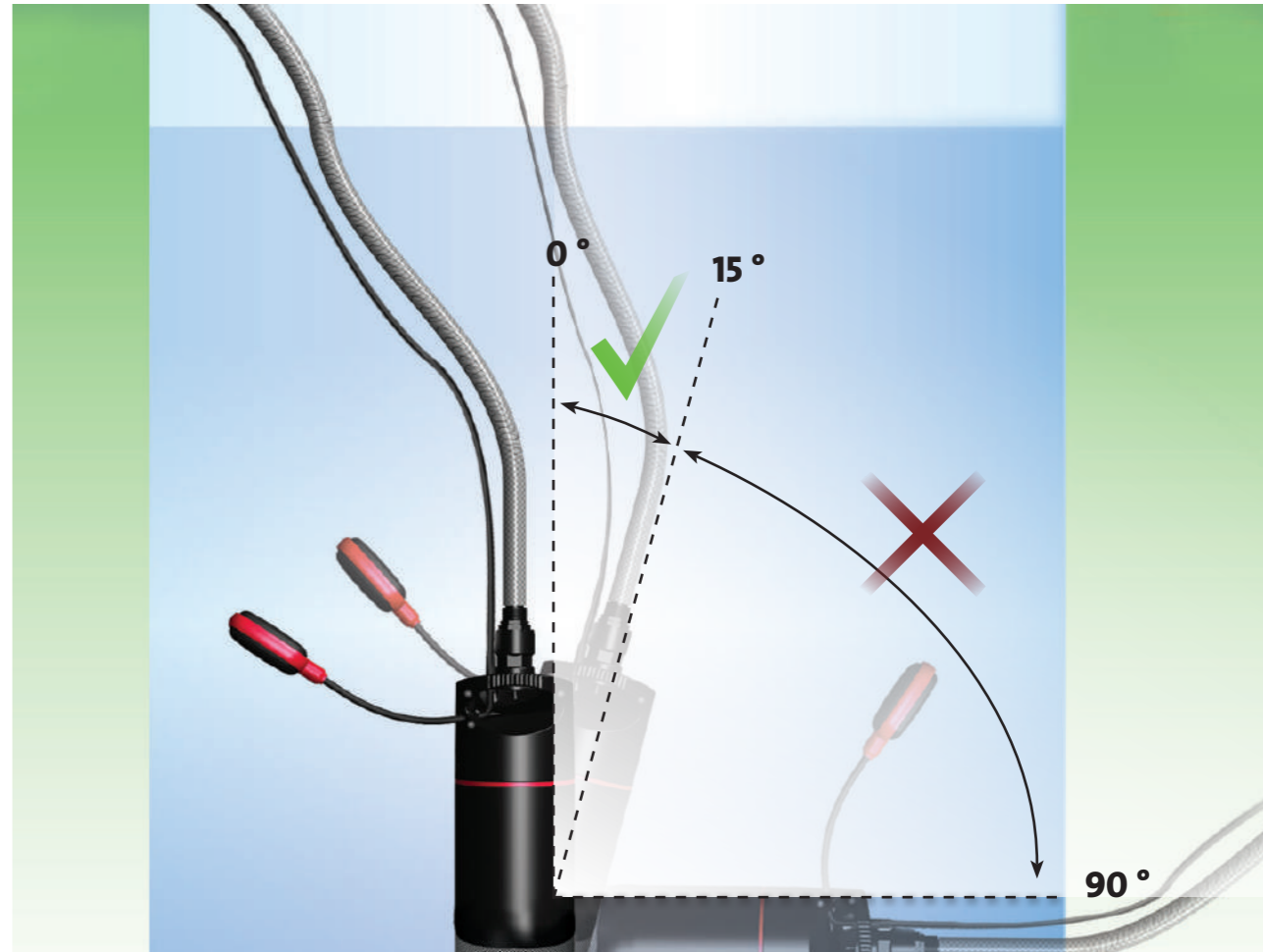

SB  
SBA

STRAINER



SIDE INLET



Max. 20 starts  
per 60 minutes.

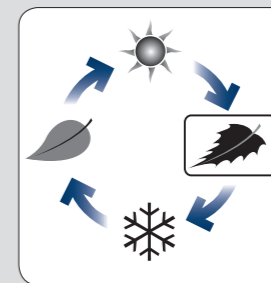
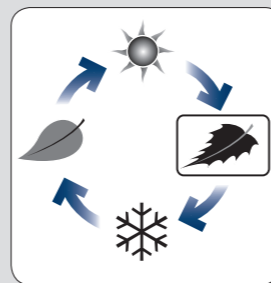
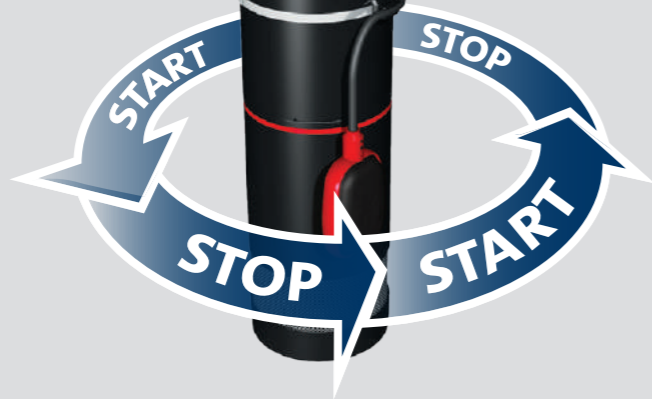
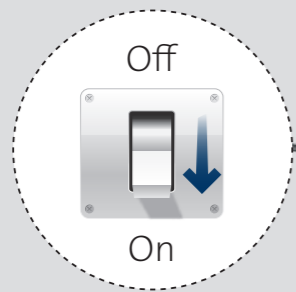

be think innovate

---

98159397 0816

ECM: 1178728

**GRUNDFOS Holding A/S**  
Poul Due Jensens Vej 7  
DK-8850 Bjerringbro  
Tel: +45 87 50 14 00  
[www.grundfos.com](http://www.grundfos.com)

**GRUNDFOS** 

The name Grundfos, the Grundfos logo, and be think innovate are registered trademarks owned by Grundfos Holding A/S or Grundfos A/S, Denmark. All rights reserved worldwide.